

Huijue Single-Mode SF Optical Module

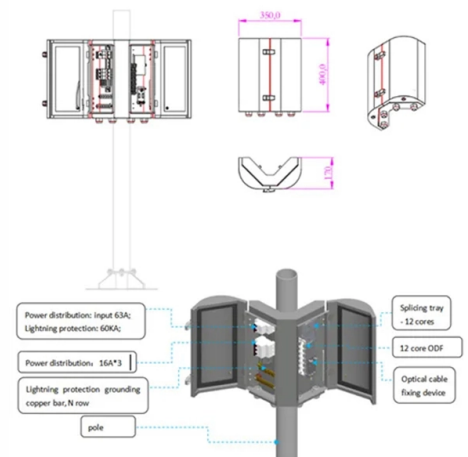

Overview

Huawei SFP-GE-LX-SM1310 1GE 1310nm 10km single-mode SFP module for Huawei switches and routers. Check real-time price, stock and lead time. Global Shipping & Tech Support. Are Attenuators Required in the Case of Short-Distance Connection Using Single-Mode Optical Modules?

Why an Interface Does Not Enter the linkdown State When Its Receiving Power Reaches the Lower Threshold?

Does a Port Frequently Alternate Between Up and Down States When a Non-Huawei-Certified. Huawei SFP-GE-LX-SM1310 is Optical Transceiver. Table 2 shows the Huawei hot switches which support SFP-GE-LX-SM1310. Table 3 shows the comparison of S-SFP-GE-LH40-SM1310. Professional Huawei SFP Module Single Mode Fiber Transceiver SFP-GE-LX-SM1310-A SFPEX is the original manufacturer of Huawei SFP SFP-GE-LX-SM1310-A - H3C 1000BASE-LX SFP Transceiver, Single Mode (1310nm, 10km, LC). 02310QBJ - Genuine Huawei SFP-10G-BXU1 10GBase, BIDI Optical Transceiver, SFP+, 10G, Single-mode Module (TX1270nm/RX1330nm, 10km, LC) Basic Information Transmitter Optical Characteristics Receiver Optical Characteristics This 02310QBJ is 100% genuine Huawei product. It won't have any compatibility. Huawei eKit offers a comprehensive series of pluggable optical modules in the Huawei eKit portfolio.

Article Content

Optical Modules for Huawei S Series Switches

Single-mode optical modules are used with single-mode fibers. Single-mode fibers support a wide band and large transmission capacity, and are used for long-distance transmission.

Huawei SFP-GE-LX-SM1310 1GE 1310nm 10km SFP Optical

Professional Huawei SFP module with 1.25Gbps data rate, 1310nm wavelength & 10km range. 100% H3C compatible with lifetime warranty.

2025 How to Identify Single-Mode vs. Multimode SFP Modules for

Learn how to identify single-mode and multimode SFP modules with our comprehensive guide. Explore SFP features, testing methods, and compatibility.

Huawei eKitEngine Optical Module Datasheet

Huawei eKit offers a comprehensive series of pluggable optical modules in the Huawei eKit portfolio. The wide variety of modules gives you flexible and plug

What is an SFP Module? An Ultimate Guide | SFP

What is an SFP Module? Small Form-factor Pluggable (SFP) module is a compact, hot-swappable transceiver used for both telecommunication and

S-SFP-GE-LH80-SM1550

QSFPs has the Huawei Compatible transceiver module S-SFP-GE-LH80-SM1550 in stock and ready to ship. We can ship them out in 24 hours after we get your order.

02310QBJ

And the Huawei SFP-10G-BXU1 10GBase, BIDI Optical Transceiver, SFP+, 10G, Single-mode Module (TX1270nm/RX1330nm, 10km, LC) is factory new with

Single Mode SFP Transceiver | Optcore

High-performance single mode SFP transceivers for long-distance networking applications. Find the perfect SFP module for your switches and devices.

Comparing Single-Mode vs Multimode SFP

Explore the differences between single-mode and multimode SFP transceivers. Find the right LC module for fast fiber connectivity and optimal

How to Choose SFP Module | FIBEYE

Price Single-mode modules are typically more expensive than multi-mode modules because they use more components and more expensive laser light sources.

10GE SFP+ Optical Modules

Single-fiber bidirectional (BIDI) optical modules must be used in pairs. For example, SFP-10G-BXU1 must be used with SFP-10G-BXD1.

Huawei SFP-10G-LR 10G SFP+ 1310nm 10km Single

The Huawei Optical Transceiver SFP-10G-LR is a versatile and high-performance 10G SFP+ module. Designed for single-mode fiber, it offers reliable 10km

Huawei SFP-GE-LX-SM1310-A Single Mode Fiber Transceiver

Professional Huawei SFP module with 1.25Gbps data rate, 1310nm wavelength & 10km range. 100% H3C compatible with lifetime warranty.

Huawei Optical Modules and Cables

Buy Genuine Huawei Optical Modules and Cables from GenuineModules with best price and fast worldwide shipping.

GE eSFP Optical Modules

This document provides an overall description of the CE12800 series switches hardware, helping you obtain detailed information about each chassis, power module, fan module, card, cable, and

Huawei SFP-10G-LR 02310QDJ Optical

The Huawei SFP 10G LR 02310QDJ Optical Transceiver is a high performance, single mode SFP+ (Small Form factor Pluggable Plus) transceiver module designed for 10 Gigabit Ethernet (10GbE)

Contact Us

For more information, pricing, or custom solutions, please contact us:

Website: <https://ourensemeeting.es>

Email: sales@ourensemeeting.es

Phone: +34 685 473 921

Address: Calle de Alcalá, 25, 28014 Madrid, Spain

This document is for informational purposes only. Specifications subject to change without notice.

